



Technical Standards and Safety Authority
 www.tssa.org
 14th Floor - Centre Tower
 3300 Bloor Street West
 Toronto Ontario M8X 2X4
 Fax: 416.231.4903
 Customer Service: 1.877.682.8772

Level 1 Risk and Safety Management Plan (RSMP)
Technical Standards and Safety Act
 Propane Storage and Handling Regulation

This Level 1 RSMP applies to:

- a facility with a total propane storage capacity of 5,000 USWG or less; or
- a facility with a fixed propane storage capacity of exactly 5,000 USWG and no more than 500 USWG of portable propane storage capacity on site.

Failure to fully complete this form may result in rejection. Making a false statement may result in a fine or prosecution under the *Technical Standards and Safety Act*

Licence Number 0033857001-C

Check applicable type of propane operations.

Cylinder Motor Fill Filling Plant Card/Keylock

Submit along with this completed application a Facility Site Plan and a Map of the Surrounding Area.

For Office Use Only

JUL 22 2013

SR #. [REDACTED]

SECTION A: GENERAL INFORMATION

The Undersigned applies to TSSA for a review for an RSMP under Ontario's *Technical Standards and Safety Act*, Propane Storage and Handling Regulation.

Company Name Canadian Tire Corporation Ontario Corporation No., if applicable _____

A Operator Name (if different from above) _____

Telephone No. (416) 544-7608 Fax No. N/A E-mail John.Lastoria@cantire.com

B Street No. 2180 Street Name / 911 Number / Address, if applicable Yonge Street

Town / City or Township / County Toronto Province ON Postal Code M4S 2B9

Mailing address if different from above.

C Street No. - Street Name / 911 Number / Address, if applicable P.O. Box 770, Station K (Account #34421)

Town / City or Township / County Toronto Province ON Postal Code M4P 3J5

Information on Container Refill Centre or Filling Plant

D Location of facility.

Street No. 1080 Street Name / 911 Number / Address, if applicable Victoria Street Nearest Major Intersection Victoria Street and Frederick Street

Town / City or Township / County Kitchener Province ON Postal Code N2B 3C4

Name of Licence Holder John Lastoria

Name of a Senior Management person as defined in the regulation holding the Record of Training (ROT). Glenn Butt ROT type 100-08

Municipality (or municipalities if the facility or its hazard distance touches multiple borders) Regional Municipality of Waterloo

This document is valid until the next licence renewal date. You are required by law to notify TSSA of any change of information.

Declaration: I am aware that it is an offence to give false information in this document and I hereby declare that the information I have given here is true and complete.

Print name	Signature	Date (dd-mm-yyyy)
Name of Licence Holder <u>John Lastoria</u>		<u>17-042013</u>
Name of Senior Management person as defined in the Regulation holding the Record of Training <u>Glenn Butt</u>		<u>17-04-2013</u>



Technical Standards and Safety Authority
www.tssa.org

14th Floor - Centre Tower
3300 Bloor Street West
Toronto Ontario M8X 2X4
Fax: 416.231.4903
Customer Service: 1.877.682.8772

Level 1 Risk and Safety Management Plan (RSMP)
Technical Standards and Safety Act
Propane Storage and Handling Regulation

SECTION A: GENERAL INFORMATION (cont'd)

Indicate the year the facility was established. 1995 Indicate the year of any significant modifications, as defined in s.1, O.Reg 211/01, since establishment. 2013 - rebuild

Identify the psig rating and serial number for each fixed propane storage tank on site.

	PSIG	Serial Number
Tank 1:	<u>250 PSIG</u>	<u>unknown at this time</u>
Tank 2:	_____	_____
Tank 3:	_____	_____

Enter capacity of propane in USWG, fixed, portable, and mobile, and provide detailed inventory that includes the number of tank/vessel for each type (fixed, portable, and mobile) and the capacity of each tank/vessel, on a separate document.

Fixed: 2000 USWG Portable: 500 USWG Mobile: 0 USWG

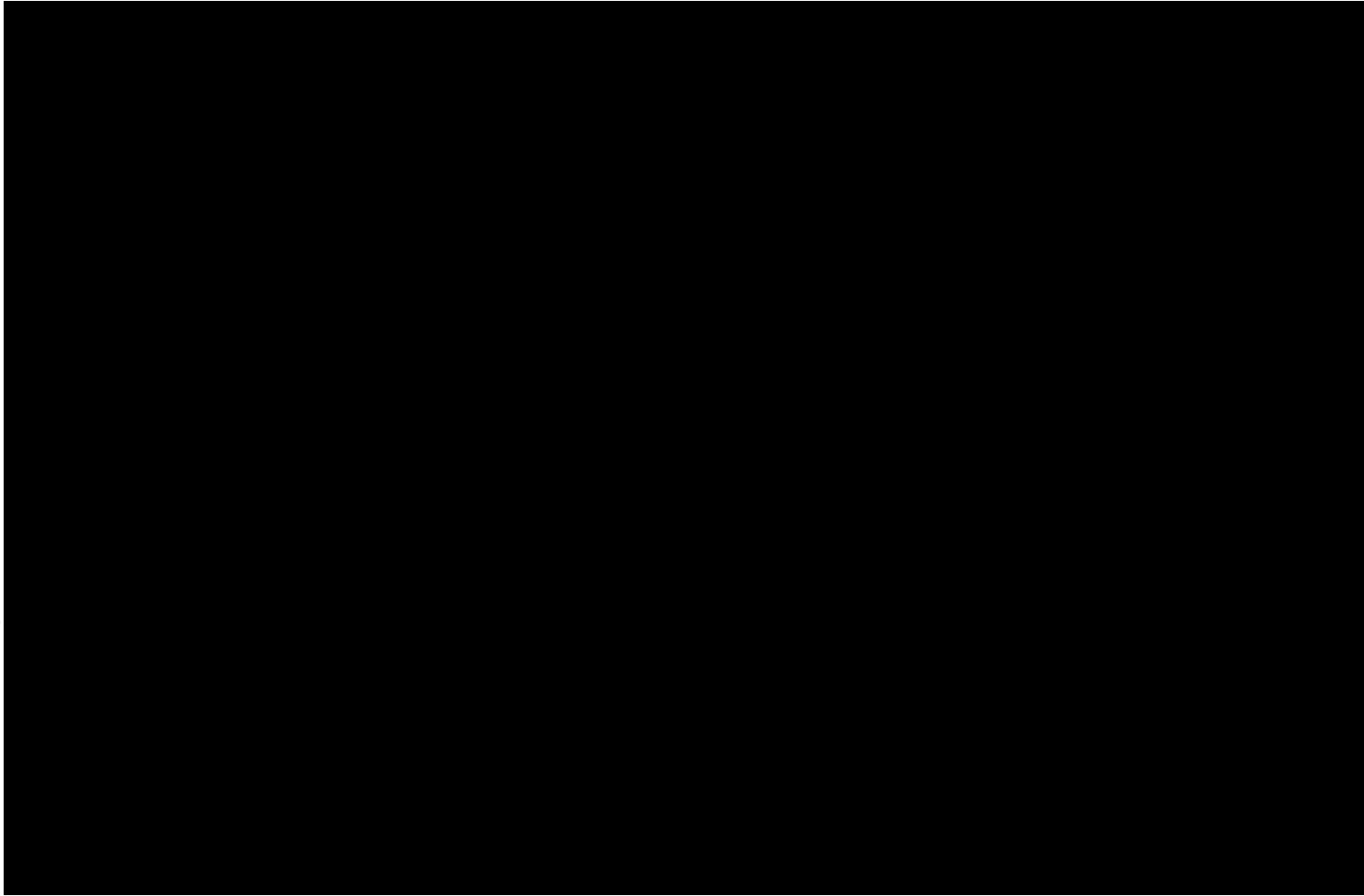

Declaration: I am aware that it is an offence to give false information in this document and I hereby declare that the information I have given here is true and complete.

Name of person completing this form (please print) John Lastoria	Official Title E H & S Specialist	
Signature 	Telephone No. (416) 544-7608	Date (dd-mm-yyyy) 16-04-2013



Technical Standards and Safety Authority
www.tssa.org

14th Floor - Centre Tower
3300 Bloor Street West
Toronto Ontario M8X 2X4
Fax: 416.231.4903
Customer Service: 1.877.682.8772

Level 1 Risk and Safety Management Plan (RSMP)
Technical Standards and Safety Act
Propane Storage and Handling Regulation

SECTION A: GENERAL INFORMATION (cont'd)

Activity Information

Name of Propane Supplier(s) Superior Propane - Ontario Regional Operations Centre		For Office Use - Party No. [REDACTED]	
Street No. 251	Street Name / 911 Number / Address, if applicable Woodlawn Road West, Unit 217		
Town / City or Township / Country Guelph		Province ON	Postal Code N1H 8J1
Telephone No. (519) 829-9845	Fax No. 519-836-7766	Contact Name Bruce Graham, Ontario Operations Manager	
E-mail grahamb@superiorpropane.com			

Name of Propane Transporter. If same as above, please check box. <input type="checkbox"/>		For Office Use - Party No. [REDACTED]	
Superior Propane - Guelph			
Street No. 7022	Street Name / 911 Number / Address, if applicable Wellington Road 124 S		
Town / City or Township / Country Guelph		Province ON	Postal Code N1H 6L3
Telephone No. (519) 831-6664	Fax No. N/A	Contact Name Chris van Herksen, Market Manager	
E-mail vanherkc@superiorpropane.com			

Off-site Cylinder and/or Mobile Storage None	Capacity stored off-site, in USWG	For Office Use - Party No. [REDACTED]	
Street No.	Street Name / 911 Number / Address, if applicable		
Town / City or Township / Country		Province	Postal Code
Telephone No.	Fax No.	Contact Name	

Note: Customer storage is not considered off-site storage.

Declaration: I am aware that it is an offence to give false information in this document and I hereby declare that the information I have given here is true and complete.

Name of person completing this form (please print) John Latoria		Official Title E H & S Specialist	
Signature 		Telephone No. (416) 544-7608	Date (dd-mm-yyyy) 17-04-2013



Technical Standards and Safety Authority
www.tssa.org

14th Floor - Centre Tower
3300 Bloor Street West
Toronto Ontario M8X 2X4
Fax: 416.231.4903
Customer Service: 1.877.682.8772

Level 1 Risk and Safety Management Plan (RSMP)
Technical Standards and Safety Act
Propane Storage and Handling Regulation

SECTION B: EMERGENCY AND PREPAREDNESS RESPONSE PLAN

The licence holder will complete Section B in consultation with the local Fire Services.

Description of the maximum volume, types and storage location of other hazardous materials on site, if any.

Gasoline; maximum amount - 125,000 litres and storage location - stored underground (to the right of the propane tank/due north).

Diesel; maximum amount - 25,000 litres and storage location - stored underground (to the right of the propane tank/due north).

An MSDS for regular unleaded gasoline is provided herein. The MSDS for premium gasoline and diesel fuel are similar and not included.

Description of fire and emergency equipment indicated on facility site map.

Fire Extinguishers - Type 20 lb. ABC

Locations; 1. inside gas bar kiosk, 2. on columns by the gasoline dispensers, and 3. at the propane filling station.

List of fire protection controls (e.g., fire detection systems, fire notification systems, alarm systems, automatic shut off devices, fusible links, etc.) and describe their function, use and operation.

1. ISC valve interlock bar (interlocked with cabinet door) - ISC valve closes when door is closed.
2. Fusible link on ISC valve - isolation valve between the tank and the downstream propane dispensing equipment.
3. Emergency Stop Buttons - one is located at the cash inside the gas bar building and one is located on a bollard surrounding the propane tank.
4. Power supply breaker inside the kiosk. This cuts all power to the propane system - shuts down pump; closes solenoid valve.

Maintenance and testing schedule for fire protection controls and devices.

Maintenance and testing is undertaken by Superior Propane according to Superior Propane's Maintenance Standard. Schedule for key equipment is:

1. Pumps (Pump every 3 months; Pump Motor: check belts monthly; grease motor every 6 months)
2. ISC Valves (test for closure every 6 months)
3. Fusible links - inspected every 6 months
4. Storage tank Relief Valves - inspect every 2 years; replacement schedule as per provincial regulations.
5. Fire extinguishers maintained by Canadian Tire in accordance with provincial regulations.

Declaration: I am aware that it is an offence to give false information in this document and I hereby declare that the information I have given here is true and complete.

Name of person completing this form (please print) John Lastoria	Official Title E H & S Specialist
Signature 	Telephone No. (416) 544-7608
	Date (dd-mm-yyyy) 17-04-2013



Technical Standards and Safety Authority
www.tssa.org

14th Floor - Centre Tower
3300 Bloor Street West
Toronto Ontario M8X 2X4
Fax: 416.231.4903
Customer Service: 1.877.682.8772

Level 1 Risk and Safety Management Plan (RSMP)
Technical Standards and Safety Act
Propane Storage and Handling Regulation

SECTION B: EMERGENCY AND PREPAREDNESS RESPONSE PLAN (cont'd)

1. Contacts for Emergency Response

1. Facility Contact Personnel - Key Contact

Name Samar Elech	For Office Use - Party No.
Official Title Agent	
Telephone No. (519) 576-4180	Fax No. (519) 576-4180
E-mail 1689.kitchener@ctpagent.ca	
Role and responsibilities in emergency Coordinate site response	

5. Facility 24-Hour Contact Person

Name Samar Elech	For Office Use - Party No.
Official Title Agent	
Cell No. (519) 221-3733	Fax No. (519) 272-1893
E-mail 1689.kitchener@ctpagent.ca	
Role and responsibilities in emergency Coordinate site response	

2. Facility Contact Personnel - Alternate Contact

Name Ronald Rameshnauth	For Office Use - Party No.
Official Title Regional Business Manager	
Telephone No. (416) 452-4929	Fax No. (905) 257-9093
E-mail ronald.rameshnauth@cantire.com	
Role and responsibilities in emergency Coordinate site response if agent unavailable	

6. Name of Facility Manager

Name Samar Elech	For Office Use - Party No.
Official Title Agent	
Telephone No. w (519) 576-4180 or c (519) 221-3733	Fax No. (519) 272-1893
E-mail 1689.kitchener@ctpagent.ca	
Role and responsibilities in emergency Coordinate site response	

3. Local Fire Services - Key Contact

Name Timothy Beckett	For Office Use - Party No.
Official Title Fire Chief, Kitchener Fire Department	E-mail timothy.beckett@kitchener.ca
Telephone No. (519) 741-2200 x5500	Fax No. (519) 741-2697
Role and responsibilities in emergency Coordinate/advise on Fire Service Response. Liaise with police.	
Fire Services Address 270 Strasburg Road, Kitchener, ON N2E 3M6	

7. Propane Supplier Key Contact Person

Name Superior Propane Hotline	For Office Use - Party No.
Official Title	E-mail N/A
Telephone No. 1-877-873-7467	Fax No. N/A
Role and responsibilities in emergency Identify and dispatch Superior Propane and or LPERGC emergency response personnel as required.	
Propane Supplier Address 7022 Wellington Road 124 S, Guelph, ON N1H 6L3	

4. Local Fire Services - Alternate Contact

Name Phil Mellor	For Office Use - Party No.
Official Title Assistant Chief Fire Prevention Officer	E-mail phil.mellor@kitchener.ca
Telephone No. (519) 741-2200 x5505	Fax No. (519) 741-2697
Role and responsibilities in emergency Alternate - Coordinate/advise on Fire Service Response. Liaise with police.	
Fire Services Address 270 Strasburg Road, Kitchener, ON N2E 3M6	

8. Municipal Contact

Name Jenn Grein	For Office Use - Party No.
Official Title Chief Administrative Officer/Corporate Project Assistant	
Telephone No. (519) 741-2200 x7092	Fax No. N/A
E-mail jenn.grein@kitchener.ca	
Municipality Name and Address City of Kitchener, PO Box 1118, Clerk's Office, 2nd Floor, Kitchener, ON N2G 4G7	

Declaration: I am aware that it is an offence to give false information in this document and I hereby declare that the information I have given here is true and complete.

Name of person completing this form (please print) John Lastoria	Official Title E H & S Specialist
Signature 	Telephone No. (416) 544-7608
	Date (dd-mm-yyyy) 17-04-2013



Technical
Standards and
Safety Authority
www.tssa.org

14th Floor - Centre Tower
3300 Bloor Street West
Toronto Ontario M8X 2X4
Fax: 416.231.4903
Customer Service: 1.877.682.8772

Level 1 Risk and Safety Management Plan (RSMP)
Technical Standards and Safety Act
Propane Storage and Handling Regulation

SECTION B: EMERGENCY AND PREPAREDNESS RESPONSE PLAN (cont'd)

2. Additional Safety Measures

Describe any other measures in place at the facility that exceed the minimum Code and Standards requirements.

None

Declaration: I am aware that it is an offence to give false information in this document and I hereby declare that the information I have given here is true and complete.

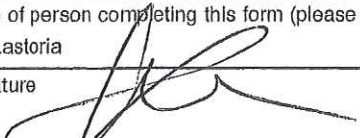
Name of person completing this form (please print) John Lastoria	Official Title E H & S Specialist	
Signature 	Telephone No. (416) 544-7608	Date (dd-mm-yyyy) 17-04-2013



Technical Standards and Safety Authority
www.tssa.org

14th Floor - Centre Tower
3300 Bloor Street West
Toronto Ontario M8X 2X4
Fax: 416.231.4903
Customer Service: 1.877.682.8772

Level 1 Risk and Safety Management Plan (RSMP)
Technical Standards and Safety Act
Propane Storage and Handling Regulation

SECTION B: EMERGENCY AND PREPAREDNESS RESPONSE PLAN (cont'd)

3. Record of Emergency Training Provided - For most recent 12-month period.

Training on Emergency Response Plan and Procedures provided to facility key contacts:

Training Date (dd-mm-yyyy) 16-01-2012	Print Name of Training Provider: FSN Training
	Print Name of Instructor: Barry Tourgis
Training Date (dd-mm-yyyy)	Print Name of Training Provider:
	Print Name of Instructor:
Training Date (dd-mm-yyyy)	Print Name of Training Provider:
	Print Name of Instructor:

Training on the facility's Emergency Management Procedures provided to staff.

Training Date (dd-mm-yyyy) 24-06-2012	Print Name of Training Provider: Site Key Contact trained Staff
	Print Name of Instructor: Samar Elech
Training Date (dd-mm-yyyy)	Print Name of Training Provider:
	Print Name of Instructor:
Training Date (dd-mm-yyyy)	Print Name of Training Provider:
	Print Name of Instructor:

On-site specific training provided to certificate holders / persons with Records of Training.

Training Date (dd-mm-yyyy) 27-03-2012	Print Name of Training Provider: Propane Training Institute trained CTC employee Jeff Roy
	Print Name of Instructor: Mike Mortin
Training Date (dd-mm-yyyy) 28-05-2012	Print Name of Training Provider: Propane Training Institute trained CTC employee Nichelle Robertson
	Print Name of Instructor: Mike Mortin
Training Date (dd-mm-yyyy) to be arranged as required	Print Name of Training Provider:
	Print Name of Instructor:

Declaration: I am aware that it is an offence to give false information in this document and I hereby declare that the information I have given here is true and complete.

Name of person completing this form (please print) John Lastoria	Official Title E H & S Specialist
Signature 	Telephone No. (416) 544-7608
	Date (dd-mm-yyyy) 17-04-2013



Technical Standards and Safety Authority
www.tssa.org

14th Floor - Centre Tower
3300 Bloor Street West
Toronto Ontario M8X 2X4
Fax: 416.231.4903
Customer Service: 1.877.682.8772

Level 1 Risk and Safety Management Plan (RSMP)
Technical Standards and Safety Act
Propane Storage and Handling Regulation

SECTION B: EMERGENCY AND PREPAREDNESS RESPONSE PLAN (cont'd)

4. Emergency Training Plan for Coming Year

Training on Emergency Response Plan and Procedures provided to facility key contacts.

Target Date (dd-mm-yyyy) TBA - 2013	Print Name of Training Provider: Superior Propane, FSN, or other
	Print Name of Instructor: to be arranged
Target Date (dd-mm-yyyy)	Print Name of Training Provider:
	Print Name of Instructor:
Target Date (dd-mm-yyyy)	Print Name of Training Provider:
	Print Name of Instructor:

Training on the facility's Emergency Management Procedures provided to staff.

Target Date (dd-mm-yyyy) TBA - 2013	Print Name of Training Provider: Key site contact to train staff
	Print Name of Instructor: Key site contact
Target Date (dd-mm-yyyy)	Print Name of Training Provider:
	Print Name of Instructor:
Target Date (dd-mm-yyyy)	Print Name of Training Provider:
	Print Name of Instructor:

On-site specific training provided to certificate holders / persons with Records of Training.

Target Date (dd-mm-yyyy) As Required	Print Name of Training Provider: Superior Propane, FSN, or other	PLEASE NOTE - a ROT is valid for 3 years
	Print Name of Instructor: to be arranged as required	
Target Date (dd-mm-yyyy)	Print Name of Training Provider:	
	Print Name of Instructor:	
Target Date (dd-mm-yyyy)	Print Name of Training Provider:	
	Print Name of Instructor:	

Declaration: I am aware that it is an offence to give false information in this document and I hereby declare that the information I have given here is true and complete.

Name of person completing this form (please print) John Lastoria	Official Title E H & S Specialist
Signature 	Telephone No. (416) 544-7608
	Date (dd-mm-yyyy) 17-04-2013



Technical Standards and Safety Authority
www.tssa.org

14th Floor - Centre Tower
3300 Bloor Street West
Toronto Ontario M8X 2X4
Fax: 416.231.4903
Customer Service: 1.877.682.8772

Level 1 Risk and Safety Management Plan (RSMP)
Technical Standards and Safety Act
Propane Storage and Handling Regulation

SECTION B: EMERGENCY AND PREPAREDNESS RESPONSE PLAN (cont'd)

The licence holder will complete Section B in consultation with the local Fire Services.

5: Emergency Response Communications Plan

Warnings and Actions

Describe who gives warnings to whom, and how and when the warning will be given (including public notification as appropriate).
The operator or alternate (both ROT staff) will contact emergency services by calling 911 and will provide warnings outlined in the attached "Propane Emergency Response Procedures" (to be posted at site and be part of employee training). If it is safe to do so, this could involve advising neighbors to evacuate. The operator may also contact Superior Propane via the emergency number identified in the ERP.

Describe what action is to be taken and by whom when a warning is issued (including details of a meeting place in a safe identified area and activating the evacuation plan, if necessary).
The operator or alternate should first follow the actions in the ERP provided herein. Staged evacuation, if the release of propane cannot be stopped by cutting electrical power may be required. The muster location is back of the facility, near the retail store, 60m away from the site and away from a dispersing propane cloud. (Note a specific muster point is not advisable since a propane plume can blow in any direction) Subsequent evacuation instructions, potentially up to the Hazard Distance to be provided by municipal emergency responders. Residences and businesses beyond the site boundary to be notified by municipal ER's.

Communication with Emergency Response Authorities

Describe when and how the licence holder will give early warning to emergency response authorities (including a process to ensure that a call is placed to 911).
When the system is operational, a ROT person will be on duty and be in the propane tank area. This person will be able to visually ascertain any abnormal events and implement the appropriate emergency response actions and notifications, including notifying emergency responders. Calling 911 will occur immediately after any attempts to shut down the system. When the system is not in operation, the ISC valve (main isolation valve) is closed, and the propane system is unattended, but shut down. Any accidents involving the propane tank during such times will require the intervention of random, nearby individuals.

Describe provisions for fire department entry when there are no operations or staffing at the propane site.
The propane tank system is located in a wide open store parking lot area that is easily accessible from Victoria Street.
Fire access routes are identified in the attached site plan.

Describe how the licence holder will ensure continual flow of updated information to authorities.
The critical information required from the license holder is information on how to shut the system down and the fill level in the tank (if known). This information will be provided to the authorities by agent - Samar Elech.
Fill level is relevant from a time-to-BLEVE perspective (a near empty tank will BLEVE sooner than a full tank if there is fire impingement on the tank).

How long will it take the facility liaison person to respond to the site.
It would take 24-hour contact, Samar Elech, approximately 30-minutes to arrive on-site after having received the emergency call.

Declaration: I am aware that it is an offence to give false information in this document and I hereby declare that the information I have given here is true and complete.

Name of person completing this form (please print) John Lastoria	Official Title E H & S Specialist
Signature 	Telephone No. (416) 544-7608
	Date (dd-mm-yyyy) 17-04-2013



Technical Standards and Safety Authority
www.tssa.org

14th Floor - Centre Tower
3300 Bloor Street West
Toronto Ontario M8X 2X4
Fax: 416.231.4903
Customer Service: 1.877.682.8772

Level 1 Risk and Safety Management Plan (RSMP)
Technical Standards and Safety Act
Propane Storage and Handling Regulation

SECTION B: EMERGENCY AND PREPAREDNESS RESPONSE PLAN (cont'd)

The licence holder will complete Section B in consultation with the local Fire Services.

6. Building and Site Security and Procedures

	Yes	No
1. Does the propane location have controlled access to limit unnecessary risk and entry (lock out procedures)?	<input type="checkbox"/>	<input checked="" type="checkbox"/>
2. Is there adequate night lighting at the site?	<input checked="" type="checkbox"/>	<input type="checkbox"/>
3. Are procedures in place that ensure access routes, aisles, storage area, filling areas and the grounds are kept clear from unwanted materials?	<input checked="" type="checkbox"/>	<input type="checkbox"/>
4. Are there procedures that capture and record the daily inspection of hoses and inspection requirements for filling systems and mechanical devices used in the transfer of propane?	<input checked="" type="checkbox"/>	<input type="checkbox"/>
5. Does the facility have procedures that include a process to isolate and purge any overfilled propane cylinders?	<input checked="" type="checkbox"/>	<input type="checkbox"/>
6. Are weighing systems validated for accuracy?	<input checked="" type="checkbox"/>	<input type="checkbox"/>
7. Are storage areas clearly marked with the vessels' capacity status (i.e., filled, empty, purged and other hazardous materials)?	<input checked="" type="checkbox"/>	<input type="checkbox"/>
8. Are quality assurance procedures in place to ensure that all valves are closed after the propane cylinders are filled?(e.g., QCC valves)	<input checked="" type="checkbox"/>	<input type="checkbox"/>
9. Is the schedule of maintenance and testing activities retained on site?	<input checked="" type="checkbox"/>	<input type="checkbox"/>

7. Water Supply

The propane licence holder should work with the local fire department to determine water supply capabilities that are available based on the propane facility's location.

	Yes	No
1. Is a pressurized water system available at the propane facility site?	<input checked="" type="checkbox"/>	<input type="checkbox"/>
2. Can the municipal fire department pump 375 GPM (1420 LPM) of water at this location?	<input checked="" type="checkbox"/>	<input type="checkbox"/>
3. What is the unobstructed distance to the closest water supply that could be used for firefighting activities? (distance in metres only)		<u>50 m</u>
4. What is the unobstructed distance to the closest approved water supply with year round access if there are no hydrants? (distance in metres only)		<u>N/A</u>

Declaration: I am aware that it is an offence to give false information in this document and I hereby declare that the information I have given here is true and complete.

Name of person completing this form (please print) John Lastoria	Official Title E H & S Specialist	
Signature 	Telephone No. (416) 544-7608	Date (dd-mm-yyyy) 17-04-2013



Technical Standards and Safety Authority
www.tssa.org

14th Floor - Centre Tower
3300 Bloor Street West
Toronto Ontario M8X 2X4
Fax: 416.231.4903
Customer Service: 1.877.682.8772

Level 1 Risk and Safety Management Plan (RSMP)
Technical Standards and Safety Act
Propane Storage and Handling Regulation

SECTION B: EMERGENCY AND PREPAREDNESS RESPONSE PLAN (cont'd)

The licence holder will complete Section B in consultation with the local Fire Services.

8. Licence holder and local Fire Services Review

To be completed by the Local Fire Services

Has the local fire service had an opportunity to review the Emergency Response and Preparedness Plan?

Yes

No

If not, please explain (e.g., no fire services).

Fire services comments, if any:

To be completed by the Licence Holder

In response to the above comments, the following action(s) is required:

The licence holder will respond to the Local Fire Services comments by: _____
(dd-mm-yyyy)

LOCAL FIRE SERVICES

The undersigned has reviewed Section B of the Risk and Safety Management Plan Fire Services.

Print name	Signature	Date (dd-mm-yyyy)
Local Fire Services Name		

Declaration: I am aware that it is an offence to give false information in this document and I hereby declare that the information I have given here is true and complete.

Name of person completing this form (please print) John Lastoria	Official Title E H & S Specialist	
Signature	Telephone No. (416) 544-7608	Date (dd-mm-yyyy) 17-04-2013



Technical
Standards and
Safety Authority
www.tssa.org

14th Floor - Centre Tower
3300 Bloor Street West
Toronto Ontario M8X 2X4
Fax: 416.231.4903
Customer Service: 1.877.682.8772

Level 1 Risk and Safety Management Plan (RSMP)
Technical Standards and Safety Act
Propane Storage and Handling Regulation

SECTION C: SUBMISSIONS

Applicant must include a Facility Site Plan and Map of Surrounding Area

Facility Site Plan.

The licence holder will submit a copy of the original facility site plan updated with the following information:

1. The storage location of fixed, portable, and mobile vessels.
2. The maximum volume, types and storage location of hazardous materials.
3. Location of permanent structures on site.
4. Access and egress points and location of barriers.
5. Location of fire and emergency equipment (e.g., sprinkler systems, extinguishers, suppression systems) on site and location of fire hydrant or water supply where available.
6. Location of emergency shut off/shut down switches/valves.

Map of Surrounding Area.

The licence holder will submit a scaled aerial map of the surrounding area showing the following information:

7. The capacity and placement of the single largest propane storage vessel, including its setback from the front, rear and side property lines.
8. GPS co-ordinates of the single largest vessel.
9. Visual indication of the single largest fixed vessel and a circle made using the distance in Table 1 as the radius from the single largest fixed vessel.
10. Clear indication of the municipality or municipalities present within the circle.
11. Visual indication of property line information.
12. The location and name of roads within or abutting the site.
13. Key note to the drawing indicating the facility's municipal address, municipal lot number(s) and concession lines as applicable, and the date the map was prepared.
14. Address and contact information for each municipality (municipal clerk or secretary-treasurers of planning board). (Refer to page 5.)
15. Complete "Required Mapping Information from Updated Site Plan" in table below.

Required Mapping Information from Updated Site Plan

Date Map Prepared (dd-mm-yyyy) 26-03-13	Capacity of single largest propane storage vessel (USWG) 2000 USWG
Tank setback coordinates. Indicate placement on the map.	
Front: 20 m	Right side property line: 145 m
Rear: 70 m	Left side property line: 10 m
GPS coordinates of single largest vessel: Lat. 43.4659 and Long. -80.4605	

Declaration: I am aware that it is an offence to give false information in this document and I hereby declare that the information I have given here is true and complete.

Name of person completing this form (please print) John Lastoria	Official Title E H & S Specialist	
Signature 	Telephone No. (416) 544-7608	Date (dd-mm-yyyy) 17-042013



Technical Standards and Safety Authority
www.tssa.org

14th Floor - Centre Tower
3300 Bloor Street West
Toronto Ontario M8X 2X4
Fax: 416.231.4903
Customer Service: 1.877.682.8772

Level 1 Risk and Safety Management Plan (RSMP)
Technical Standards and Safety Act
Propane Storage and Handling Regulation

SECTION C: SUBMISSIONS (cont'd)

Applicant must include a Facility Site Plan and Map of Surrounding Area

Table 1: Distance Table

Water Capacity (litres)	Nominal Water Capacity (USWG)	Distance to 1 psi overpressure (m)
1,890	500	155
3,780	1,000	195
4,920	1,300	213
6,620	1,750	235
7,130	1,885	241
7,560	2,000	246
18,900	5,000	333

Formula: $D = 16.94 \times (1.524 \times C)^{1/3}$
 D = Distance to overpressure of 1 psi (meters)
 C = Tank Total Capacity in USWG

Parameters: Density of Propane is 0.5033 kg per litre @ 15 C
 Assume all vessels are 80% full
 1 gallon [US, liquid] = 0.003785411784 cubic meter
 1 cubic metre = 264.17 USWG

Hazard Distance Chart (EPA-TNT model)

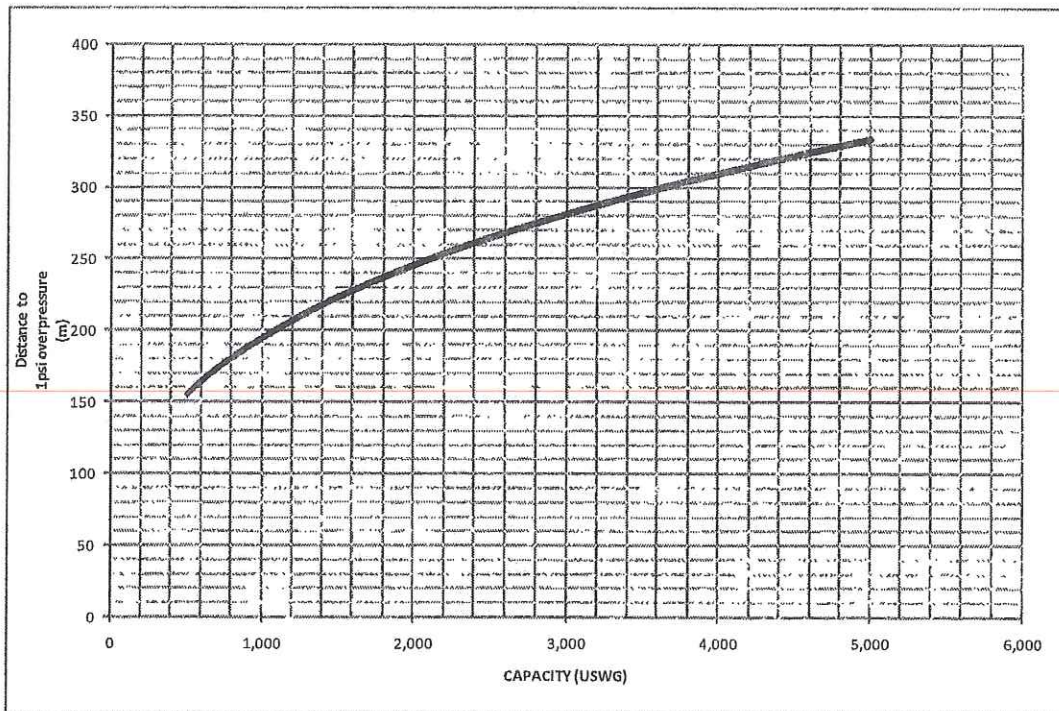



Technical Standards and Safety Authority
www.tssa.org

14th Floor - Centre Tower
3300 Bloor Street West
Toronto Ontario M8X 2X4
Fax: 416.231.4903
Customer Service: 1.877.682.8772

Level 1 Risk and Safety Management Plan (RSMP)
Technical Standards and Safety Act
Propane Storage and Handling Regulation

SECTION C: SUBMISSIONS (cont'd)
Applicant must include a Facility Site Plan and Map of Surrounding Area

As an accompaniment to the Map of Surrounding Area, provide the following information about buildings and features present within the circle in Table 2.

Table 2: Buildings and Features

Buildings and Features Present within the Circle on the Map of the Surrounding Area AND Name and Address of Closest Building or Feature	* Number of Buildings and Features (mark with an "X")				Distance from Tank to Closest Building or Feature
	0	1	2-10	11+	
Industrial buildings or parks or golf courses Name: multiple industrial buildings 400+ m away Address: _____ City: _____ Province _____ Postal Code _____	X				0 m
[REDACTED]				X	125 m
Commercial building units specifically retail, restaurants, entertainment, theatres, and sporting complexes. Name: Canadian Tire Retail Store, Home Hardware, & Other Retailers Address: _____ City: _____ Province _____ Postal Code _____			X		75 m
Commercial building units – continuous occupancy specifically hotels, campgrounds, and resorts. Name: None Address: _____ City: _____ Province _____ Postal Code _____	X				0 m
Sensitive institutions specifically hospitals, schools and day cares, nursing and retirement homes, mental health institutions, and prisons. Name: None Address: _____ City: _____ Province _____ Postal Code _____	X				0 m
Emergency responders specifically fire stations, ambulance stations, and police stations. Name: None Address: _____ City: _____ Province _____ Postal Code _____	X				0 m

* For multi-unit buildings, count each unit as "1".

Declaration: I am aware that it is an offence to give false information in this document and I hereby declare that the information I have given here is true and complete.

Name of person completing this form (please print) John Lastorla	Official Title E H & S Specialist
Signature	Telephone No. (416) 544-7608
	Date (dd-mm-yyyy) 17-04-2013



Technical Standards and Safety Authority
www.tssa.org

14th Floor - Centre Tower
3300 Bloor Street West
Toronto Ontario M8X 2X4
Fax: 416.231.4903
Customer Service: 1.877.682.8772

Level 1 Risk and Safety Management Plan (RSMP)
Technical Standards and Safety Act
Propane Storage and Handling Regulation

WORKSHEET

Portable Storage Additional Information Worksheet

Cylinder Size	Capacity in USWG	Quantity	Total Volume in USWG
# 420	123.9		
# 100	29.5	2	59
# 40	11.75		
# 33.3	9.62	10	96
# 30	8.8	5	44
# 20	5.8	50	290
# 10	2.9		
# 5	1.5	5	8
Total Cylinder Capacity EST. 500 USWG			

Tanks Stored On-site Not Connected for Use

Tank Size In USWG	Quantity	Total Volume in USWG
Total Tank Capacity 0 USWG		

Total Cylinder Capacity	500 USWG
Total Tank Capacity	0 USWG
Total Portable Capacity (Total Cylinder Capacity + Total Tank Capacity)	500 USWG

©2011 Google – Imagery
 ©2011 Digital Globe, Cnes/Spot Image, First Base Solutions,
 Map data ©2011 Google, Tele Atlas

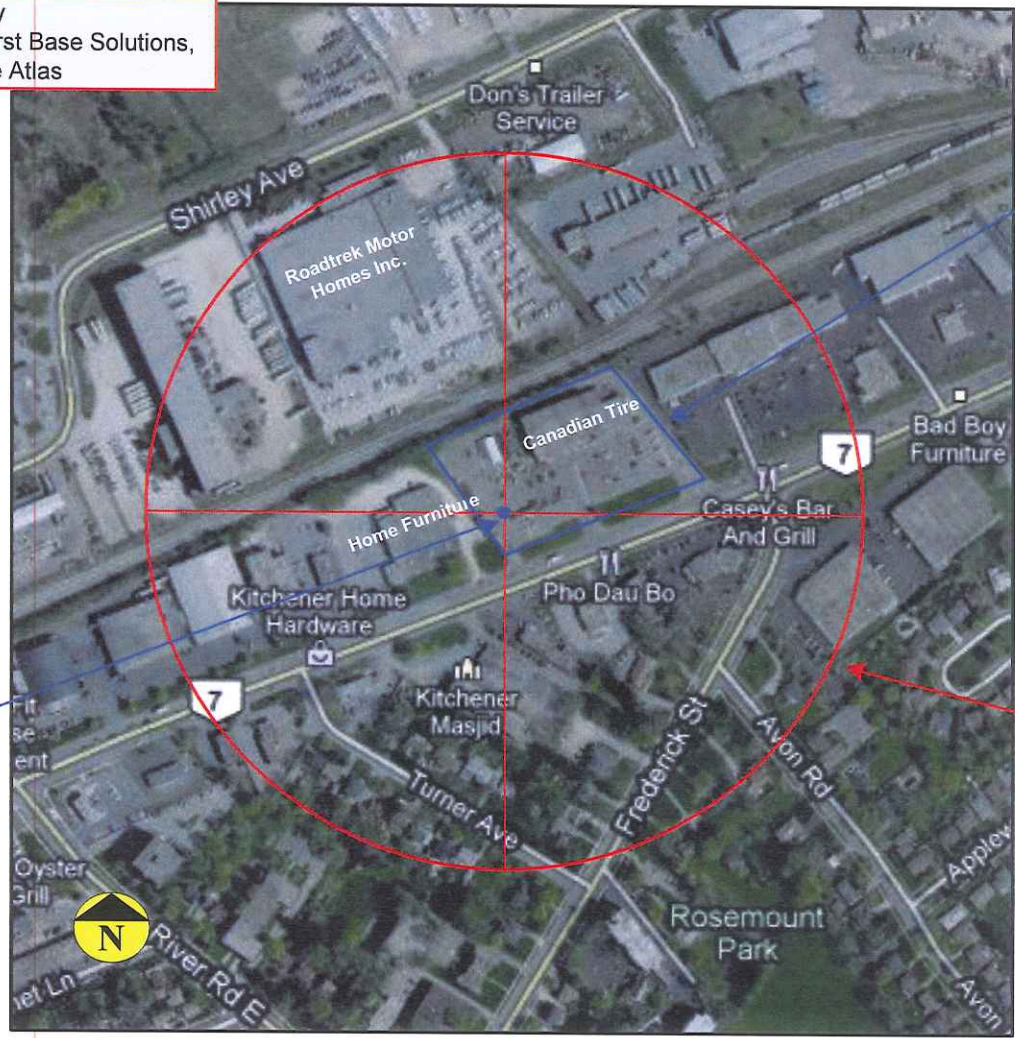

Site Boundary

2000 USWG Propane Tank

Hazard Distance = 246 m

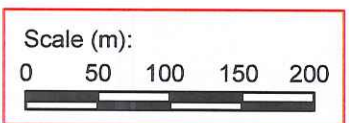

Setback Distances to Site Boundary	North: 70 m East: 145 m South: 20 m West: 10 m	Municipality (ies) within the 1 psi overpressure circle: City of Kitchener/Municipality of Waterloo	<h3 style="text-align: center;">Map of Surrounding Area</h3> <p style="text-align: center;">Canadian Tire 1080 Victoria Street, Kitchener, ON N2B 3C4 <i>Lot 2-3 Plan 971, Lot 3-4 Plan 972, City of Kitchener</i></p>
Capacity of Propane Storage Tank: Capacity of Propane Storage Tank = 2000 USWG	Municipal Contact: Jenn Grein Chief Administrative Officer/Corporate Project Assistant City of Kitchener P.O. Box 1118 Clerk's Office, 2 nd Floor Kitchener, ON, N2G 4G7 Tel: (519) 741-2200 x7092 Email: Jenn.greind@kitchener.ca		
GPS Co-ordinates of Propane Storage Tank: GPS Co-ordinates = 43.4659, -80.4605		Drawn by: K. Almey Date: March 26 2013	
Circular Distance to 1 psi overpressure: Denoted by circle centred on tank; radial distance = 246 m			

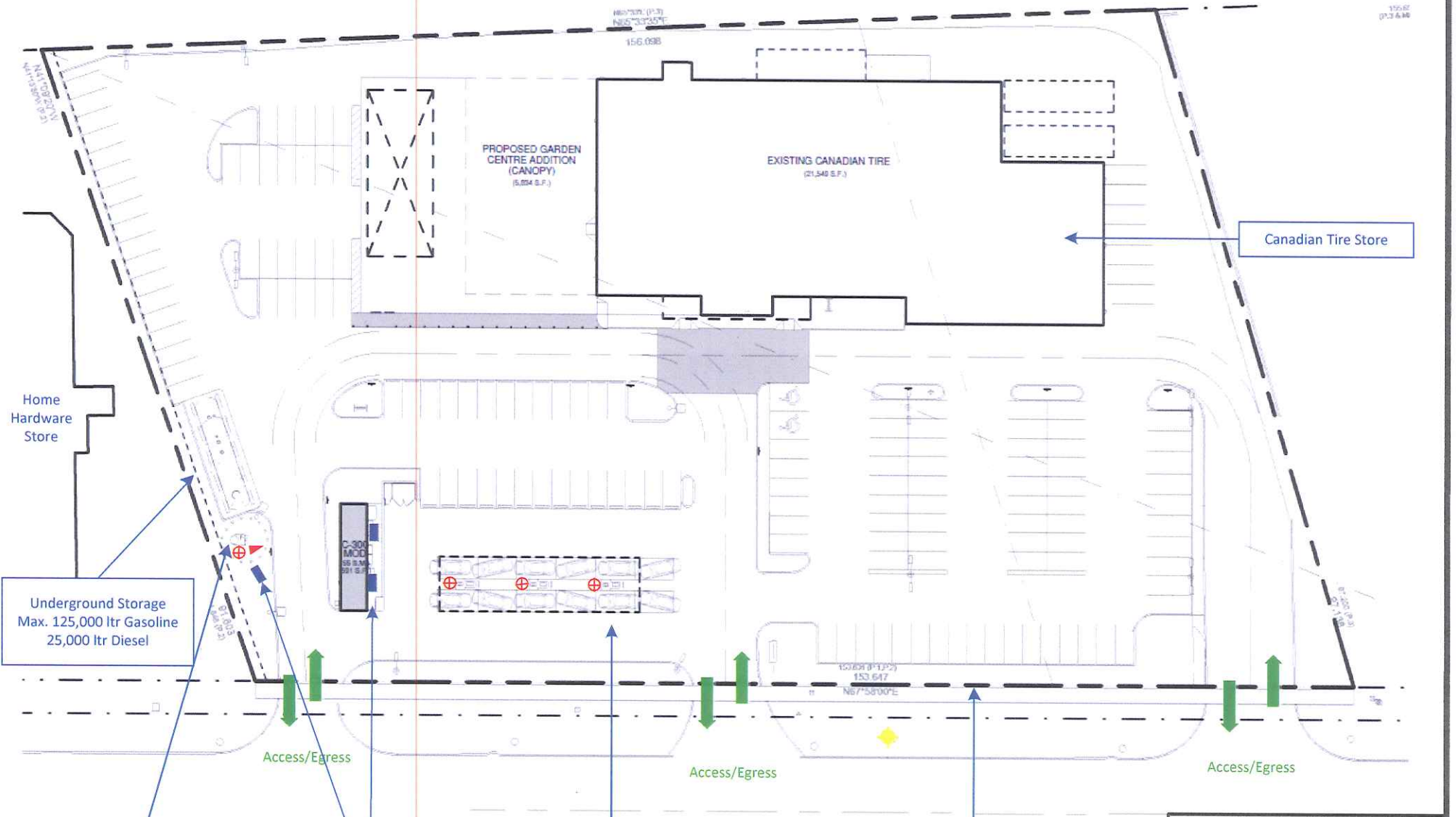

Canadian Tire Store

Home Hardware Store

Underground Storage
Max. 125,000 ltr Gasoline
25,000 ltr Diesel

2000 USWG Propane Tank

Cylinder Cages (Max. total of 3)

Gasoline Pumps & Kiosk Area

Site Boundary

Access/Egress

Access/Egress

Access/Egress

VICTORIA STREET NORTH

CANADIAN TIRE STORE #1689
Kitchener, Ontario

Legend:

-  Fire Extinguisher
-  Emergency Stop Button
-  Fire Hydrant