



Technical Standards and Safety Authority
www.tssa.org

14th Floor - Centre Tower
3300 Bloor Street West
Toronto Ontario M8X 2X4
Fax: 416.231.4903
Customer Service: 1.877.682.8772

Level 1 Risk and Safety Management Plan (RSMP)
Technical Standards and Safety Act
Propane Storage and Handling Regulation

This Level 1 RSMP applies to: . a facility with a total propane storage capacity of 5,000 USWG or less; or
a facility with a fixed propane storage capacity of exactly 5,000 USWG and no more than 500 USWG of portable propane storage capacity on site.

<p style="text-align: center; font-weight: bold;">Failure to fully complete this form may result in rejection. Making a false statement may result in a fine or prosecution under the <i>Technical Standards and Safety Act</i></p> <p>Licence Number <input style="width: 100%;" type="text" value="76539102"/></p> <p>Check applicable type of propane operations.</p> <p><input checked="" type="checkbox"/> Cylinder <input type="checkbox"/> Motor Fill <input type="checkbox"/> Filling Plant <input type="checkbox"/> Card/Keylock</p> <p>Submit along with this completed application a Facility Site Plan and a Map of the Surrounding Area.</p>	<p style="text-align: center; font-weight: bold;">For Office Use Only</p> <div style="border: 1px solid black; height: 100px; width: 100%; background-color: black;"></div>
---	---

SECTION A: GENERAL INFORMATION

The Undersigned applies to TSSA for a review for an RSMP under Ontario's *Technical Standards and Safety Act*, Propane Storage and Handling Regulation.

A Company Name		Ontario Corporation No., if applicable	
Canadian Tire Corporation Ltd.			
Operator Name (if different from above) Donald Jackson (Agent),.....tel: 705-876-7268			
Telephone No. 416-544-7608	Fax No. 416-544-6163	E-mail john.lastoria@cantire.com	
B Street No. Street Name / 911 Number / Address, if applicable			
2180 Yonge St. 17th Floor			
Town / City or Township / County Toronto		Province Ontario	Postal Code M4P 2V8
Mailing address if different from above.			
C Street No. Street Name / 911 Number / Address, if applicable			
P.O. Box 770 Station K (Account #34421)			
Town / City or Township / County Toronto		Province Ontario	Postal Code M4P 3J5

Information on Container Refill Centre or Filling Plant			
Location of facility.			
D Street No.		Street Name / 911 Number / Address, if applicable	
1050		Chemong Rd.	
Town / City or Township / County Peterborough		Province Ontario	Postal Code K9H 7S2
Nearest Major Intersection Chemong Road & Milroy Drive			

Name of Licence Holder John Lastoria on behalf of Canadian Tire Corporation Ltd.	
Name of a Senior Management person as defined in the regulation holding the Record of Training (ROT) Glenn Butt	ROT type 100-08
Municipality (or municipalities if the facility or its hazard distance touches multiple borders) Peterborough	
Hours of operation. <div style="background-color: black; width: 100%; height: 40px;"></div>	

This document is valid until the next licence renewal date. You are required by law to notify TSSA of any change of information.

Declaration: I am aware that it is an offence to give false information in this document and I hereby declare that the information I have given here is true and complete.

Print name Name of Licence Holder John Lastoria	Signature 	Date (dd-mm-yyyy) 26/05/11
Name of Senior Management person as defined in the Regulation holding the Record of Training Glen Butt		



Technical Standards and Safety Authority
www.tssa.org

14th Floor - Centre Tower
3300 Bloor Street West
Toronto Ontario M8X 2X4
Fax: 416.231.4903
Customer Service: 1.877.682.8772

Level 1 Risk and Safety Management Plan (RSMP)
Technical Standards and Safety Act
Propane Storage and Handling Regulation

SECTION A: GENERAL INFORMATION (cont'd)

Indicate the year the facility was established.
2004

Indicate the year of any significant modifications, as defined in s.1, O.Reg 211/01, since establishment.
None since opening

Identify the psig rating and serial number for each fixed propane storage tank on site.

	PSIG	Serial Number
Tank 1:	250	1103
Tank 2:	_____	_____
Tank 3:	_____	_____

Enter capacity of propane in USWG, fixed, portable, and mobile, and provide detailed inventory that includes the number of tank/vessel for each type (fixed, portable, and mobile) and the capacity of each tank/vessel, on a separate document.

Fixed: 2000 USWG Portable: 279 USWG Mobile: 0

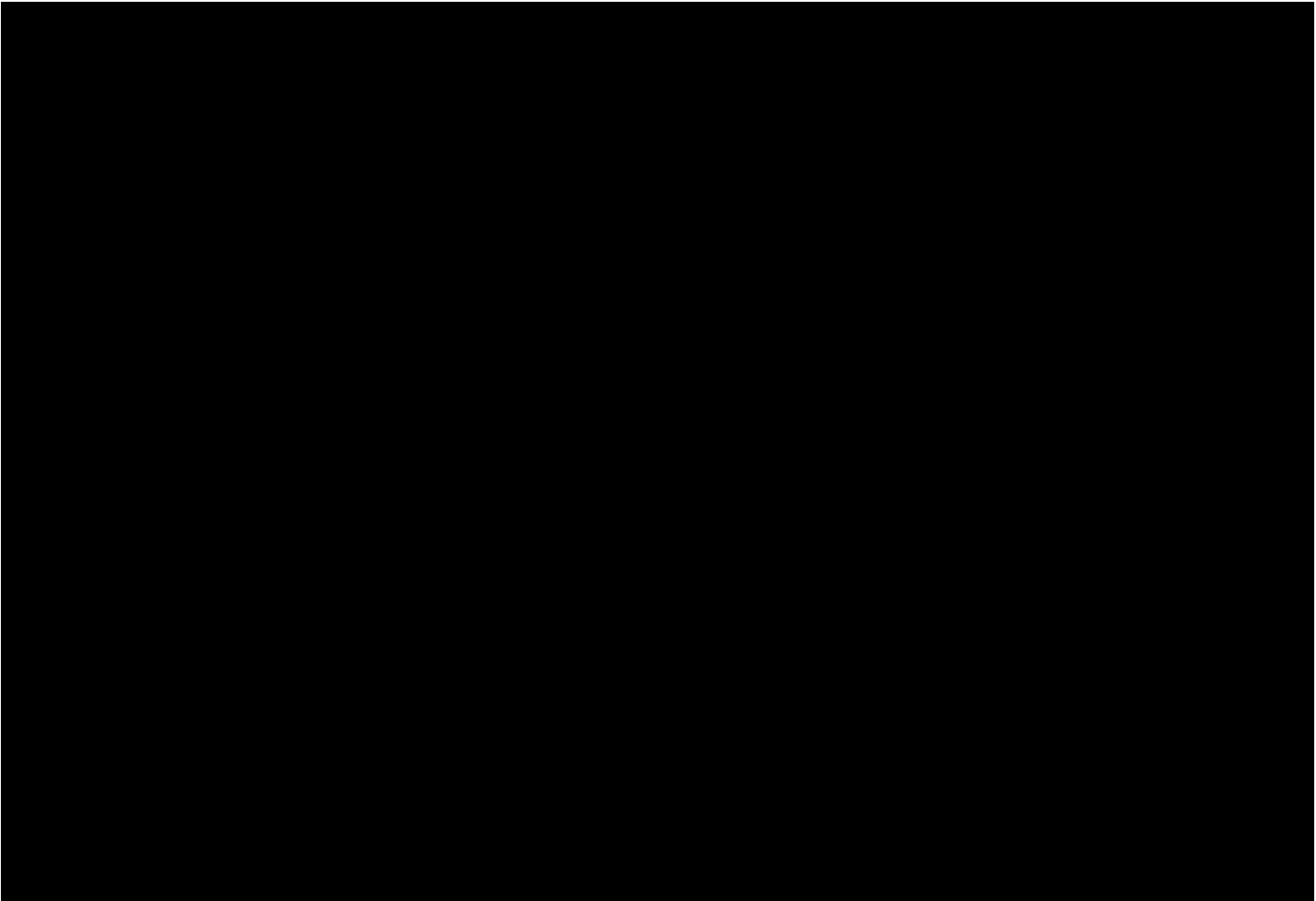

Declaration: I am aware that it is an offence to give false information in this document and I hereby declare that the information I have given here is true and complete.

Name of person completing this form (please print) Marcello Oliverio	Official Title Chief Engineer, Superior Propane
Signature 	Telephone No. 905-285-2480 ext. 5327
	Date (dd-mm-yyyy) 26/05/2011



Technical Standards and Safety Authority
www.tssa.org

14th Floor - Centre Tower
3300 Bloor Street West
Toronto Ontario M8X 2X4
Fax: 416.231.4903
Customer Service: 1.877.682.8772

Level 1 Risk and Safety Management Plan (RSMP)
Technical Standards and Safety Act
Propane Storage and Handling Regulation

SECTION A: GENERAL INFORMATION (cont'd)

Activity Information

Name of Propane Supplier(s)		For Office Use - Party No.	
Superior Propane - Ontario Regional Operations Centre		[REDACTED]	
Street No.	Street Name / 911 Number / Address, if applicable		
251	Woodlawn Road West, Unit 217		
Town / City or Township / Country		Province	Postal Code
Guelph		Ontario	N1H 8J1
Telephone No.	Fax No.	Contact Name	
1-877-873-7467	519-836-7766	Mike Mullins	
E-mail			
mullinsm@superiorpropane.com			

Name of Propane Transporter. If same as above, please check box. <input type="checkbox"/>		For Office Use - Party No.	
Superior Propane - Peterborough		[REDACTED]	
Street No.	Street Name / 911 Number / Address, if applicable		
6722	Hwy 7		
Town / City or Township / Country		Province	Postal Code
Peterborough		Ontario	K9J 6X5
Telephone No.	Fax No.	Contact Name	
705-927-2234		Mark Wakeford	
E-mail			
wakeform@superiorpropane.com			

Off-site Cylinder and/or Mobile Storage	Capacity stored off-site, in USWG	For Office Use - Party No.
None		[REDACTED]
Street No.	Street Name / 911 Number / Address, if applicable	
Town / City or Township / Country		Postal Code
Telephone No.	Fax No.	Contact Name

Note: Customer storage is not considered off-site storage.

Declaration: I am aware that it is an offence to give false information in this document and I hereby declare that the information I have given here is true and complete.

Name of person completing this form (please print)	Official Title	
Marcello Oliverio	Chief Engineer, Superior Propane	
Signature	Telephone No.	Date (dd-mm-yyyy)
	905-285-2480 ext. 5327	26/05/2011



Technical Standards and Safety Authority
www.tssa.org

14th Floor - Centre Tower
3300 Bloor Street West
Toronto Ontario M8X 2X4
Fax: 416.231.4903
Customer Service: 1.877.682.8772

Level 1 Risk and Safety Management Plan (RSMP)
Technical Standards and Safety Act
Propane Storage and Handling Regulation

SECTION B: EMERGENCY AND PREPAREDNESS RESPONSE PLAN

The licence holder will complete Section B in consultation with the local Fire Services.

Description of the maximum volume, types and storage location of other hazardous materials on site, if any.

Gasoline ~3 underground tanks with a capacity of 150 000 litres. They are located on east side of property between gas dispensers and car wash building about 30 m from the propane tank.

An MSDS for regular unleaded gasoline is provided herein. MSDS for premium gasoline and diesel are similar and not included.

48 x 20 lb cylinders

Description of fire and emergency equipment indicated on facility site map.

1. Fire Extinguisher Locations: 1. Inside gas bar building 2. On columns by gasoline dispensers 3. At the bulk propane tank filling station
2. Emergency stop push button - mounted on a post near the propane tank. This shuts down the pump and closes a solenoid valve upstream of hoses.
3. Power supply breaker inside the gas bar building. This cuts all power to the propane system - shuts down pump; closes solenoid valve.

List of fire protection controls (e.g., fire detection systems, fire notification systems, alarm systems, automatic shut off devices, fusible links, etc.) and describe their function, use and operation.

1. Fusible link on ISC valve - isolation valve between the tank and the downstream propane dispensing equipment.
2. Emergency stop push button - mounted on a post near the propane tank. This shuts down the pump and closes a solenoid valve upstream of hoses.
3. Power supply breaker inside the gas bar building. This cuts all power to the propane system - shuts down pump; closes solenoid valve.

Maintenance and testing schedule for fire protection controls and devices.

Maintenance and testing is undertaken by Superior Propane according to Superior Propane's Maintenance Standard. Schedule for key equipment is:

1. Pumps (Pump every 3 months; Pump Motor: check belts monthly; grease motor every 6 months); 2. ISC Valves (test for closure every 6 months)
3. Fusible links - inspected every 6 months; 4. Storage tank Relief Valves - inspect every 2 years; replacement schedule as per provincial regulations.

Maintenance records are kept in a maintenance log at the site and kept for 5 years.

Declaration: I am aware that it is an offence to give false information in this document and I hereby declare that the information I have given here is true and complete.

Name of person completing this form (please print) Marcello Oliverio	Official Title Chief Engineer - Superior Propane
Signature 	Telephone No. 905-285-2480 ext. 5327
	Date (dd-mm-yyyy) 28/05/2011



Technical Standards and Safety Authority
www.tssa.org

14th Floor - Centre Tower
3300 Bloor Street West
Toronto Ontario M8X 2X4
Fax: 416.231.4903
Customer Service: 1.877.682.8772

Level 1 Risk and Safety Management Plan (RSMP)
Technical Standards and Safety Act
Propane Storage and Handling Regulation

SECTION B: EMERGENCY AND PREPAREDNESS RESPONSE PLAN (cont'd)

1. Contacts for Emergency Response

1. Facility Contact Personnel - Key Contact		5. Facility 24-Hour Contact Person	
Name Donald Jackson	For Office Use - Party No.	Name Donald Jackson	For Office Use - Party No.
Official Title Agent		Official Title Agent	
Telephone No. 705-876-7268	Fax No. 705-876-7268	Cell No. 705-760-4312	Fax No. 705-876-7268
E-mail 1333.Peterborough_No@ctpagent.ca		E-mail 1333.Peterborough_No@ctpagent.ca	
Role and responsibilities in emergency Coordinate site response & implement emergency response procedure. Liaise with municipal emergency responders.		Role and responsibilities in emergency Coordinate site response & implement emergency response procedure. Liaise with municipal emergency responders.	
2. Facility Contact Personnel - Alternate Contact		6. Name of Facility Manager	
Name Ron DiMambro	For Office Use - Party No.	Name Donald Jackson	For Office Use - Party No.
Official Title Regional Bus Mgr		Official Title Agent	
Telephone No. 905-706-3602	Fax No. 905-665-1370	Telephone No. 705-876-7268	Fax No. 705-876-7268
E-mail ron.dimambro@cantire.com		E-mail 1333.Peterborough_No@ctpagent.ca	
Role and responsibilities in emergency Coordinate site response & implement emergency response procedure if agent unavailable. Liaise with municipal emergency responders.		Role and responsibilities in emergency Coordinate site response & implement emergency response procedure. Liaise with municipal emergency responders.	
3. Local Fire Services - Key Contact		7. Propane Supplier Key Contact Person	
Name Trent Gervais	For Office Use - Party No.	Name Superior Propane Hotline	For Office Use - Party No.
Official Title Fire Chief		Official Title	
Telephone No. 705-745-3283	Fax No. 705-745-2460	Telephone No. 1-877-873-7467	Fax No.
E-mail t.gervais@peterborough.ca		E-mail	
Role and responsibilities in emergency Coordinate/advise on Fire Service response and liaise with police and CTC contact.		Role and responsibilities in emergency Identify and dispatch Superior Propane and or LPERGC emergency response personnel as required.	
4. Local Fire Services - Alternate Contact		8. Municipal Contact	
Name Ron Sparks	For Office Use - Party No.	Name Brian Horton	For Office Use - Party No.
Official Title Deputy Fire Chief		Official Title CAO - Emergency & Risk Management	
Telephone No. 705-745-3284	Fax No. 705-745-2460	Telephone No. 705-742-7777 ext. 1810	Fax No.
E-mail rsparks@peterborough.ca		E-mail bhorton@peterborough.ca	
Role and responsibilities in emergency Alternate - Coordinate/advise on Fire Service response and liaise with police and CTC contact.		Municipality Peterborough	

Declaration: I am aware that it is an offence to give false information in this document and I hereby declare that the information I have given here is true and complete.

Name of person completing this form (please print) Marcello Oliverio	Official Title Chief Engineer - Superior Propane
Signature 	Telephone No. 905-285-2480 ext. 5327
	Date (dd-mm-yyyy) 26/05/2011



Technical Standards and Safety Authority
www.tssa.org

14th Floor - Centre Tower
3300 Bloor Street West
Toronto Ontario M8X2X4
Fax: 416.231.4903
Customer Service: 1.877.682.8772

Level 1 Risk and Safety Management Plan (RSMP)
Technical Standards and Safety Act
Propane Storage and Handling Regulation

SECTION B: EMERGENCY AND PREPAREDNESS RESPONSE PLAN (cont'd)

2. Additional Safety Measures

Describe any other measures in place at the facility that exceed the minimum Code and Standards requirements.

Emergency Shut Off push button to shut down pump and close solenoid valve upstream of dispensing hoses.

Declaration: I am aware that it is an offence to give false information in this document and I hereby declare that the information I have given here is true and complete.

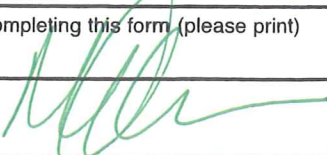
Name of person completing this form (please print) Marcello Oliverio	Official Title Chief Engineer - Superior Propane	
Signature 	Telephone No. 905-285-2480 ext. 5327	Date (dd-mm-yyyy) 26/05/2011



Technical Standards and Safety Authority
www.tssa.org

14th Floor - Centre Tower
3300 Bloor Street West
Toronto Ontario M8X 2X4
Fax: 416.231.4903
Customer Service: 1.877.682.8772

Level 1 Risk and Safety Management Plan (RSMP)
Technical Standards and Safety Act
Propane Storage and Handling Regulation

SECTION B: EMERGENCY AND PREPAREDNESS RESPONSE PLAN (cont'd)

3: Record of Emergency Training Provided - For most recent 12-month period.

Training on Emergency Response Plan and Procedures provided to facility key contacts:

Training Date (dd-mm-yyyy)	Print Name of Training Provider: None <i>Superior Propane</i>
	Print Name of Instructor:
Training Date (dd-mm-yyyy)	Print Name of Training Provider:
<i>15/06/2011</i>	Print Name of Instructor:
Training Date (dd-mm-yyyy)	Print Name of Training Provider:
	Print Name of Instructor:

Training on the facility's Emergency Management Procedures provided to staff:

Training Date (dd-mm-yyyy)	Print Name of Training Provider: None <i>Superior Propane</i>
<i>15/06/2011</i>	Print Name of Instructor:
Training Date (dd-mm-yyyy)	Print Name of Training Provider:
	Print Name of Instructor:
Training Date (dd-mm-yyyy)	Print Name of Training Provider:
	Print Name of Instructor:

On-site specific training provided to certificate holders / persons with Records of Training:

Training Date (dd-mm-yyyy)	Print Name of Training Provider:
May 2010	Print Name of Instructor: Cathy Joss ("Please note: ROT training and certification is valid for a 3 year period".)
Training Date (dd-mm-yyyy)	Print Name of Training Provider:
	Print Name of Instructor:
Training Date (dd-mm-yyyy)	Print Name of Training Provider:
	Print Name of Instructor:

Declaration: I am aware that it is an offence to give false information in this document and I hereby declare that the information I have given here is true and complete.

Name of person completing this form (please print)	Official Title
Marcello Oliverio	Chief Engineer - Superior Propane
Signature	Telephone No.
	905-285-2480 ext. 5327
	Date (dd-mm-yyyy)
	28/05/2011



Technical Standards and Safety Authority
www.tssa.org

14th Floor - Centre Tower
3300 Bloor Street West
Toronto Ontario M8X 2X4
Fax: 416.231.4903
Customer Service: 1.877.682.8772

Level 1 Risk and Safety Management Plan (RSMP)
Technical Standards and Safety Act
Propane Storage and Handling Regulation

SECTION B: EMERGENCY AND PREPAREDNESS RESPONSE PLAN (cont'd)

4. Emergency Training Plan for Coming Year

Training on Emergency Response Plan and Procedures provided to facility key contacts.

Target Date (dd-mm-yyyy) Q4 2011	Print Name of Training Provider: Superior Propane or alternate
	Print Name of Instructor: to be arranged
Target Date (dd-mm-yyyy)	Print Name of Training Provider:
	Print Name of Instructor:
Target Date (dd-mm-yyyy)	Print Name of Training Provider:
	Print Name of Instructor:

Training on the facility's Emergency Management Procedures provided to staff.

Target Date (dd-mm-yyyy) Q4 2011	Print Name of Training Provider: Key site contact to train staff
	Print Name of Instructor: to be arranged
Target Date (dd-mm-yyyy)	Print Name of Training Provider:
	Print Name of Instructor:
Target Date (dd-mm-yyyy)	Print Name of Training Provider:
	Print Name of Instructor:

On-site specific training provided to certificate holders / persons with Records of Training.

Target Date (dd-mm-yyyy) As Required	Print Name of Training Provider: Superior Propane/FSN
	Print Name of Instructor: to be arranged - Please note: ROT training and certification is valid for a 3 year period.
Target Date (dd-mm-yyyy)	Print Name of Training Provider:
	Print Name of Instructor:
Target Date (dd-mm-yyyy)	Print Name of Training Provider:
	Print Name of Instructor:

Declaration: I am aware that it is an offence to give false information in this document and I hereby declare that the information I have given here is true and complete.

Name of person completing this form (please print) Marcello Oliverio	Official Title Chief Engineer - Superior Propane
Signature 	Telephone No. 905-285-2480 ext. 5327
	Date (dd-mm-yyyy) 26/05/2011



Technical Standards and Safety Authority
www.tssa.org

14th Floor - Centre Tower
3300 Bloor Street West
Toronto Ontario M8X 2X4
Fax: 416.231.4903
Customer Service: 1.877.682.8772

Level 1 Risk and Safety Management Plan (RSMP)
Technical Standards and Safety Act
Propane Storage and Handling Regulation

SECTION B: EMERGENCY AND PREPAREDNESS RESPONSE PLAN (cont'd)

The licence holder will complete Section B in consultation with the local Fire Services.

5. Emergency Response Communications Plan

Warnings and Actions

Describe who gives warnings to whom, and how and when the warning will be given (including public notification as appropriate).

The owner/operator or alternate (both ROT staff) will contact emergency services by calling 911 and will provide warnings as outlined in the attached

Propane Emergency Response Procedures (to be posted at site and be part of employee training). If it is safe to do so, this could involve advising neighbours to evacuate. The owner/operator may also contact Superior Propane via the emergency number identified in the ERP.

Describe what action is to be taken and by whom when a warning is issued (including details of a meeting place in a safe identified area and activating the evacuation plan, if necessary).

The owner/operator or alternate should first follow the actions in the ERP's provided herein. Staged evacuation, if the release of propane cannot be stopped by cutting electrical power may be required. Initial muster locations will be on the northwest end of the parking lot, at least 120 m from the site and away from a dispersing propane cloud. Subsequent evacuation instructions potentially up to the Hazard Distance to be provided by municipal emergency responders.

Residences and businesses beyond the site boundary to be notified by municipal emergency responders.

Communication with Emergency Response Authorities

Describe when and how the licence holder will give early warning to emergency response authorities (including a process to ensure that a call is placed to 911).

When the system is operational, site staff will be on duty and be in the propane tank area. The Key Contact or alternate will be implementing ER actions and notifications, including notifying emergency responders. Calling 911 will occur immediately after any attempts to shut down the system.

When the system is not in operation, the ISC valve (main isolation valve) is closed, and the propane system is unattended, but is shutdown. Any accidents involving the propane tank during such times will require the intervention of random, nearby individuals.

Describe provisions for fire department entry when there are no operations or staffing at the propane site.

The propane tank system is located in a wide open area that is easily accessible. Egress will not be impeded.

The access routes for fire trucks are identified in the attached site plan.

Describe how the licence holder will ensure continual flow of updated information to authorities.

The critical information required from the license holder is information on how to shut the system down and the fill level in the tank (if known). This will be provided either verbally if site staff are at site or by cell phone during off hours.

Fill level is relevant from a time-to-BLEVE perspective (a near empty tank will BLEVE sooner than a full tank if there is fire impingement on the tank).

How long will it take the facility liaison person to respond to the site.

Approximately 10 minutes after having received the emergency call.

Declaration: I am aware that it is an offence to give false information in this document and I hereby declare that the information I have given here is true and complete.

Name of person completing this form (please print) Marcello Oliverio	Official Title Chief Engineer - Superior Propane
Signature 	Telephone No. 905-285-2480 ext. 5327
	Date (dd-mm-yyyy) 26/05/2011



Technical Standards and Safety Authority
www.tssa.org

14th Floor - Centre Tower
3300 Bloor Street West
Toronto Ontario M8X 2X4
Fax: 416.231.4903
Customer Service: 1.877.682.8772

Level 1 Risk and Safety Management Plan (RSMP)
Technical Standards and Safety Act
Propane Storage and Handling Regulation

SECTION B: EMERGENCY AND PREPAREDNESS RESPONSE PLAN (cont'd)

The licence holder will complete Section B in consultation with the local Fire Services.

6. Building and Site Security and Procedures

	Yes	No
1. Does the propane location have controlled access to limit unnecessary risk and entry (lock out procedures)?	<input type="checkbox"/>	<input checked="" type="checkbox"/>
2. Is there adequate night lighting at the site?	<input checked="" type="checkbox"/>	<input type="checkbox"/>
3. Are procedures in place that ensure access routes, aisles, storage area, filling areas and the grounds are kept clear from unwanted materials?	<input checked="" type="checkbox"/>	<input type="checkbox"/>
4. Are there procedures that capture and record the daily inspection of hoses and inspection requirements for filling systems and mechanical devices used in the transfer of propane?	<input checked="" type="checkbox"/>	<input type="checkbox"/>
5. Does the facility have procedures that include a process to isolate and purge any overfilled propane cylinders?	<input checked="" type="checkbox"/>	<input type="checkbox"/>
6. Are weighing systems validated for accuracy?	<input checked="" type="checkbox"/>	<input type="checkbox"/>
7. Are storage areas clearly marked with the vessels' capacity status (i.e., filled, empty, purged and other hazardous materials)?	<input type="checkbox"/>	<input checked="" type="checkbox"/>
8. Are quality assurance procedures in place to ensure that all valves are closed after the propane cylinders are filled?(e.g., QCC valves)	<input checked="" type="checkbox"/>	<input type="checkbox"/>
9. Is the schedule of maintenance and testing activities retained on site?	<input checked="" type="checkbox"/>	<input type="checkbox"/>

7. Water Supply

The propane licence holder should work with the local fire department to determine water supply capabilities that are available based on the propane facility's location.

	Yes	No
1. Is a pressurized water system available at the propane facility site?	<input checked="" type="checkbox"/>	<input type="checkbox"/>
2. Can the municipal fire department pump 375 GPM (1420 LPM) of water at this location?	<input checked="" type="checkbox"/>	<input type="checkbox"/>
3. What is the unobstructed distance to the closest water supply that could be used for firefighting activities? (distance in metres only)		<u>110 m</u>
4. What is the unobstructed distance to the closest approved water supply with year round access if there are no hydrants? (distance in metres only)		<u>N/A</u>

Declaration: I am aware that it is an offence to give false information in this document and I hereby declare that the information I have given here is true and complete.

Name of person completing this form (please print) Marcello Oliverio	Official Title Chief Engineer - Superior Propane	
Signature 	Telephone No. 905-285-2480 ext. 5327	Date (dd-mm-yyyy) 26/05/2011



Technical Standards and Safety Authority
www.tssa.org

14th Floor - Centre Tower
3300 Bloor Street West
Toronto Ontario M8X2X4
Fax: 416.231.4903
Customer Service: 1.877.682.8772

Level 1 Risk and Safety Management Plan (RSMP)
Technical Standards and Safety Act
Propane Storage and Handling Regulation

SECTION B: EMERGENCY AND PREPAREDNESS RESPONSE PLAN (cont'd)

The licence holder will complete Section B in consultation with the local Fire Services.

8. Licence holder and local Fire Services Review

To be completed by the Local Fire Services

Has the local fire service had an opportunity to review the Emergency Response and Preparedness Plan?

Yes

No

If not, please explain (e.g., no fire services).

Fire services comments, if any:

To be completed by the Licence Holder

In response to the above comments, the following action(s) is required:

The licence holder will respond to the Local Fire Services comments by: _____

(dd-mm-yyyy)

LOCAL FIRE SERVICES

The undersigned has reviewed Section B of the Risk and Safety Management Plan Fire Services.

Print name	Signature	Date (dd-mm-yyyy)
Local Fire Services Name		

Declaration: I am aware that it is an offence to give false information in this document and I hereby declare that the information I have given here is true and complete.

Name of person completing this form (please print)	Official Title	
Signature	Telephone No.	Date (dd-mm-yyyy)

May 30, 2011

Chief Trent Gervais
Fire Chief
Peterborough Fire & Rescue
210 Sherbrooke St.
Peterborough, ON
Canada
K9J 2N3

Dear Chief Gervais;

We kindly request that you review this Risk & Safety Management Plan for the Canadian Tire Facility, located at 1050 Chemong Road in Peterborough, as per Ontario Regulation 211X01.

Please complete page 11, sign, and return to:

John Lastoria
EH & S Specialist
Canadian Tire Petroleum Network Development
Canadian Tire Corporation
2180 Young Street,
Toronto, ON M4P 2V8
Phone: (416) 544-7608
Fax: (416) 544-6163

A response by June 16, 2011 would be greatly appreciated.

Sincerely,

John Lastoria
EH & S Specialist for Canadian Tire Corporation

Enclosure: 1



Technical Standards and Safety Authority
www.tssa.org

14th Floor - Centre Tower
3300 Bloor Street West
Toronto Ontario M8X 2X4
Fax: 416.231.4903
Customer Service: 1.877.682.8772

Level 1 Risk and Safety Management Plan (RSMP)
Technical Standards and Safety Act
Propane Storage and Handling Regulation

SECTION C: SUBMISSIONS

Applicant must include a Facility Site Plan and Map of Surrounding Area

Facility Site Plan.

The licence holder will submit a copy of the original facility site plan updated with the following information:

1. The storage location of fixed, portable, and mobile vessels.
2. The maximum volume, types and storage location of hazardous materials.
3. Location of permanent structures on site.
4. Access and egress points and location of barriers.
5. Location of fire and emergency equipment (e.g., sprinkler systems, extinguishers, suppression systems) on site and location of fire hydrant or water supply where available.
6. Location of emergency shut off/shut down switches/valves.

Map of Surrounding Area.

The licence holder will submit a scaled aerial map of the surrounding area showing the following information:

7. The capacity and placement of the single largest propane storage vessel, including its setback from the front, rear and side property lines.
8. GPS co-ordinates of the single largest vessel.
9. Visual indication of the single largest fixed vessel and a circle made using the distance in Table 1 as the radius from the single largest fixed vessel.
10. Clear indication of the municipality or municipalities present within the circle.
11. Visual indication of property line information.
12. The location and name of roads within or abutting the site.
13. Key note to the drawing indicating the facility's municipal address, municipal lot number(s) and concession lines as applicable, and the date the map was prepared.
14. Address and contact information for each municipality (municipal clerk or secretary-treasurers of planning board). (Refer to page 5.)
15. Complete "**Required Mapping Information from Updated Site Plan**" in table below .

Required Mapping Information from Updated Site Plan

Date Map Prepared (dd-mm-yyyy) 26/05/2011	Capacity of single largest propane storage vessel (USWG) 2000
Tank setback coordinates. Indicate placement on the map.	
Front: 33 m (SW)	Right side property line: 220 m (NW)
Rear: 116 m (NE)	Left side property line: 59 m (SE)
GPS coordinates of single largest vessel: Lat. 44.3251, Long. -78.3364	

Declaration: I am aware that it is an offence to give false information in this document and I hereby declare that the information I have given here is true and complete.

Name of person completing this form (please print) Marcello Oliverio	Official Title Chief Engineer - Superior Propane
Signature 	Telephone No. 905-285-2480 ext. 5327
	Date (dd-mm-yyyy) 26/05/2011



Technical Standards and Safety Authority
www.tssa.org

14th Floor - Centre Tower
3300 Bloor Street West
Toronto Ontario M8X 2X4
Fax: 416.231.4903
Customer Service: 1.877.682.8772

Level 1 Risk and Safety Management Plan (RSMP)
Technical Standards and Safety Act
Propane Storage and Handling Regulation

SECTION C: SUBMISSIONS (cont'd)

Applicant must include a Facility Site Plan and Map of Surrounding Area

Table 1: Distance Table

Water Capacity (litres)	Nominal Water Capacity (USWG)	Distance to 1 psi overpressure (m)
1,890	500	155
3,780	1,000	195
4,920	1,300	213
6,620	1,750	235
7,130	1,885	241
7,560	2,000	246
18,900	5,000	333

Formula: $D = 16.94 \times (1.524 \times C)^{1/3}$

D = Distance to overpressure of 1 psi (meters)
C = Tank Total Capacity in USWG

Parameters: Density of Propane is 0.5033 kg per litre @ 15 C
Assume all vessels are 80% full
1 gallon [US, liquid] = 0.003785411784 cubic meter
1 cubic metre = 264.17 USWG

Hazard Distance Chart (EPA-TNT model)

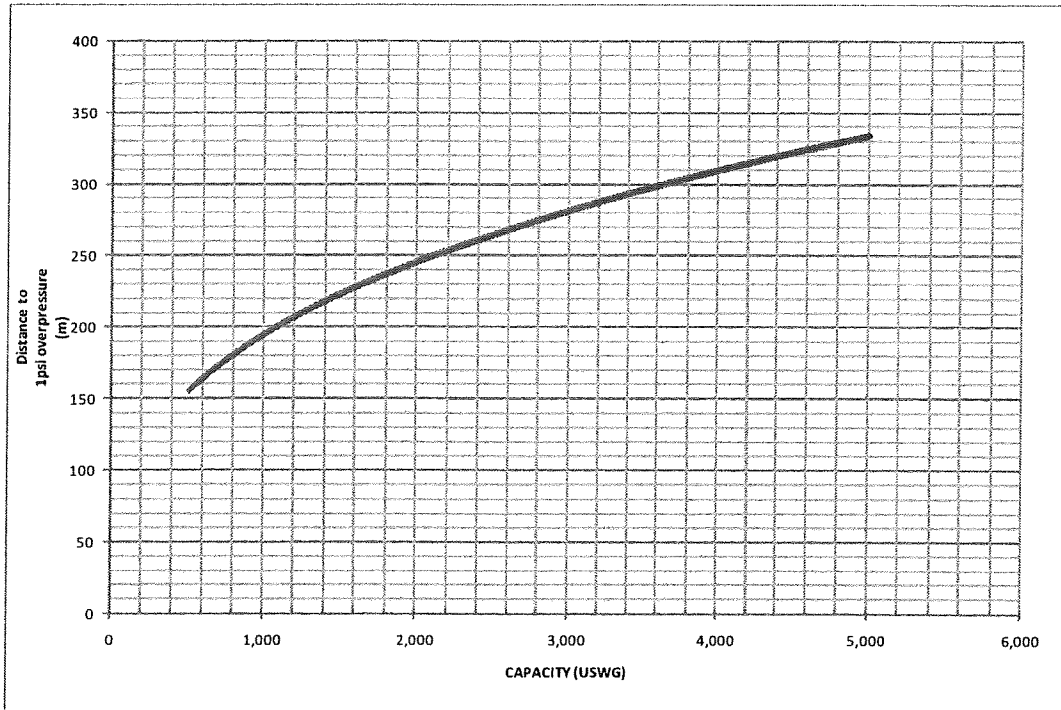

Declaration: I am aware that it is an offence to give false information in this document and I hereby declare that the information I have given here is true and complete.

Name of person completing this form (please print) Nothing completed on this page.		Official Title	
Signature		Telephone No.	Date (dd-mm-yyyy)



Technical Standards and Safety Authority
www.tssa.org

14th Floor - Centre Tower
3300 Bloor Street West
Toronto Ontario M8X 2X4
Fax: 416.231.4903
Customer Service: 1.877.682.8772

Level 1 Risk and Safety Management Plan (RSMP)
Technical Standards and Safety Act
Propane Storage and Handling Regulation

SECTION C: SUBMISSIONS (cont'd)
Applicant must include a Facility Site Plan and Map of Surrounding Area

As an accompaniment to the Map of Surrounding Area, provide the following information about buildings and features present within the circle in Table 2.

Table 2: Buildings and Features

Buildings and Features Present within the Circle on the Map of the Surrounding Area AND Name and Address of Closest Building or Feature	* Number of Buildings and Features (mark with an "X")				Distance from Tank to Closest Building or Feature
	0	1	2-10	11+	
Industrial buildings or parks or golf courses Name: _____ Address: _____ City: _____ Province _____ Postal Code _____	x				0 m
Residential building units specifically permanent single family dwellings, condominiums, and apartments Name: _____ Address: _____ City: _____				x	75 m
Commercial building units specifically retail, restaurants, entertainment, theatres, and sporting complexes. Name: Various retail stores and restaurants including McDonald's, Walmart and Arby's Address: _____ City: _____ Province _____ Postal Code _____			x		107 m
Commercial building units – continuous occupancy specifically hotels, campgrounds, and resorts. Name: _____ Address: _____ City: _____ Province _____ Postal Code _____	x				0 m
Sensitive institutions specifically hospitals, schools and day cares, nursing and retirement homes, mental health institutions, and prisons. Name: Kawartha Haliburton Children's Aid Society Address: 1100 Chemong Road City: Peterborough Province ON Postal Code _____		x			225 m
Emergency responders specifically fire stations, ambulance stations, and police stations. Name: _____ Address: _____ City: _____ Province _____ Postal Code _____	x				0 m

* For multi-unit buildings, count each unit as "1".

Declaration: I am aware that it is an offence to give false information in this document and I hereby declare that the information I have given here is true and complete.

Name of person completing this form (please print) <i>M. OLIVERO</i>	Official Title <i>CHIEF ENGINEER</i>
Signature <i>[Signature]</i>	Telephone No. <i>416-905-285-2480</i> Date (dd-mm-yyyy) <i>May 29/2014</i>



Technical Standards and Safety Authority
www.tssa.org

14th Floor - Centre Tower
3300 Bloor Street West
Toronto Ontario M8X2X4
Fax: 416.231.4903
Customer Service: 1.877.682.8772

Level 1 Risk and Safety Management Plan (RSMP)
Technical Standards and Safety Act
Propane Storage and Handling Regulation

SECTION C: SUBMISSIONS (cont'd)

Applicant must include a Facility Site Plan and Map of Surrounding Area

Portable Storage Additional Information Sheet

Cylinder Size	Capacity in USWG	Quantity	Total Volume in USWG
# 420	123.9		
# 100	29.5		
# 40	11.75		
# 33.3	9.62		
# 30	8.8		
# 20	5.8	48	279 USWG
# 10	2.9		
# 5	1.5		
Total Cylinder Capacity 279 USWG			

Tanks Stored On-site Not Connected for Use

Tank Size In USWG	Quantity	Total Volume in USWG
None <i>2000 USWG</i>	<i>1</i>	<i>2000 USWG</i>
		<i>Kelly Almey</i>
		<i>Superior Propane</i>
Total Tank Capacity		

Total Cylinder Capacity	279 USWG
Total Tank Capacity	<i>2000 USWG</i>
Total Portable Capacity	279 USWG

Declaration: I am aware that it is an offence to give false information in this document and I hereby declare that the information I have given here is true and complete.

Name of person completing this form (please print) Marcello Oliverio	Official Title Chief Engineer - Superior Propane
Signature 	Telephone No. 905-285-2480 ext. 5327
	Date (dd-mm-yyyy) 26/05/2011

SITE PLAN: CANADIAN TIRE - PETERBOROUGH (ON) STORE 1050 CHEMONG ROAD, PETERBOROUGH ON K9H 7S2

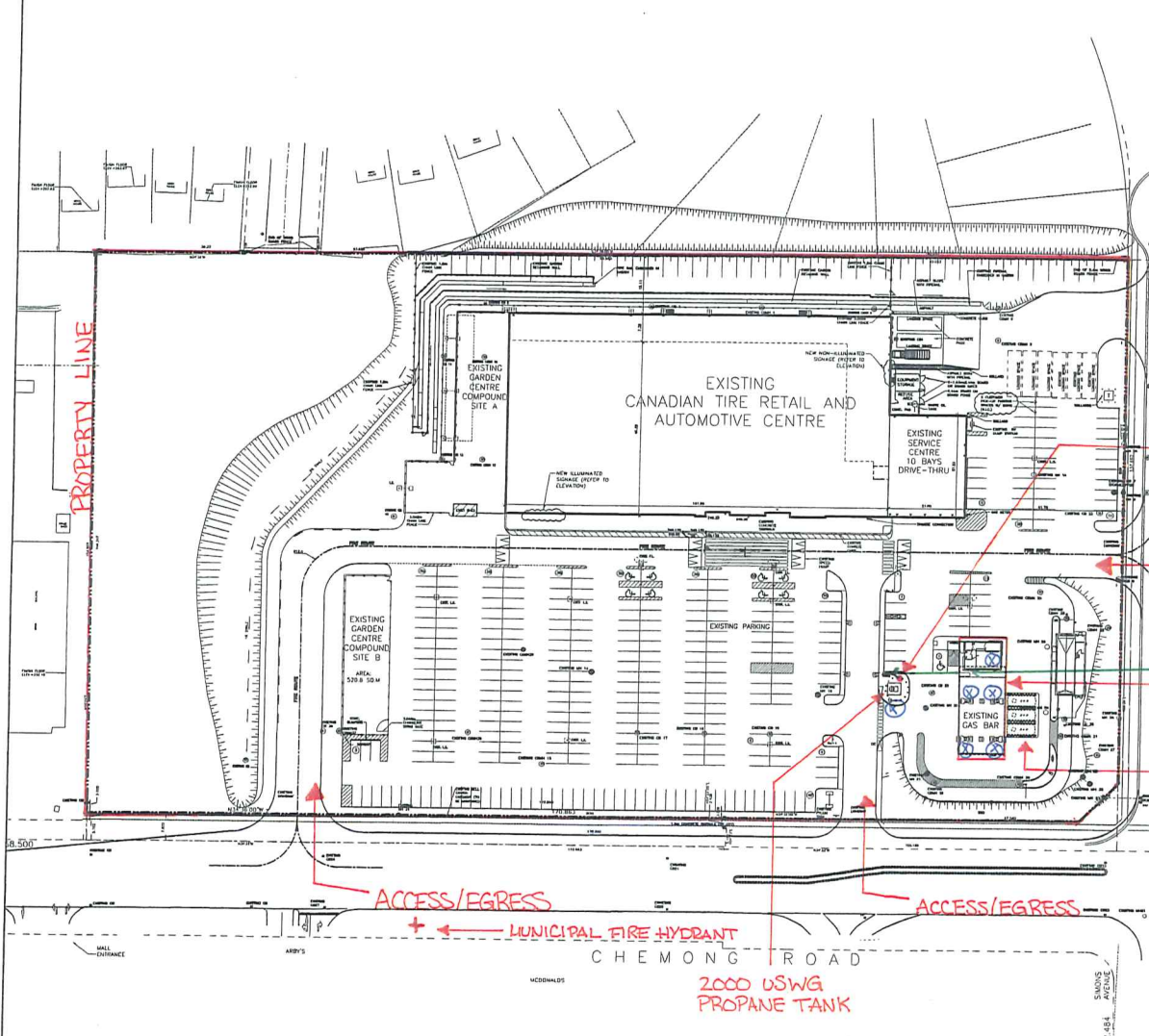

NEW STATISTICS

1. **LOT AREA**
LOT AREA = 60, 000 SQ. FT.

2. **BRANDING FLOOR AREA**

DESCRIPTION	AREA	TOTAL
1.0 CANADIAN TIRE STORE	4,300 SQ. FT.	4,300 SQ. FT.
2.0 GAS BAR	800 SQ. FT.	800 SQ. FT.
3.0 GAS TANK	1,000 SQ. FT.	1,000 SQ. FT.
TOTAL BRANDING FLOOR AREA	6,100 SQ. FT.	6,100 SQ. FT.

3. **OVERALL FOOTPRINT**
FOOTPRINT = 7,000 SQ. FT.

4. **PARKING SPACES**

DESCRIPTION	NUMBER OF SPACES	TYPE
4.1 15' X 30' (ST. 1) SPACES	4,300	ST. 1
4.2 15' X 30' (ST. 2) SPACES	800	ST. 2
4.3 15' X 30' (ST. 3) SPACES	800	ST. 3
4.4 15' X 30' (ST. 4) SPACES	1,000	ST. 4
4.5 15' X 30' (ST. 5) SPACES	1,000	ST. 5
4.6 15' X 30' (ST. 6) SPACES	800	ST. 6
4.7 15' X 30' (ST. 7) SPACES	800	ST. 7
TOTAL PARKING SPACES	10,500	10,500

5. **PAVING PRODUCTS**

DESCRIPTION	AREA	TOTAL
5.1 ASPHALT	4,300 SQ. FT.	4,300 SQ. FT.
5.2 ASPHALT	800 SQ. FT.	800 SQ. FT.
5.3 ASPHALT	800 SQ. FT.	800 SQ. FT.
5.4 ASPHALT	1,000 SQ. FT.	1,000 SQ. FT.
5.5 ASPHALT	1,000 SQ. FT.	1,000 SQ. FT.
5.6 ASPHALT	800 SQ. FT.	800 SQ. FT.
5.7 ASPHALT	800 SQ. FT.	800 SQ. FT.
TOTAL PAVING PRODUCTS	10,500 SQ. FT.	10,500 SQ. FT.

6. **GROUND FLOOR AREA (GFC) TOTAL**

DESCRIPTION	AREA	TOTAL
6.1 RETAIL	4,300 SQ. FT.	4,300 SQ. FT.
6.2 SERVICE	1,000 SQ. FT.	1,000 SQ. FT.
6.3 OFFICE	800 SQ. FT.	800 SQ. FT.
6.4 SERVICE DRIVE	800 SQ. FT.	800 SQ. FT.
6.5 TANK	800 SQ. FT.	800 SQ. FT.
TOTAL GROUND FLOOR AREA (GFC) TOTAL	7,700 SQ. FT.	7,700 SQ. FT.

7. **OUTDOOR GARDEN CENTRE AREA**

DESCRIPTION	AREA	TOTAL
7.1 GARDEN CENTRE	1,000 SQ. FT.	1,000 SQ. FT.
7.2 GARDEN CENTRE	1,000 SQ. FT.	1,000 SQ. FT.
TOTAL OUTDOOR GARDEN CENTRE AREA	2,000 SQ. FT.	2,000 SQ. FT.

8. **PAVED AREA**

8.1 TOTAL PAVED AREA = 10,500 SQ. FT.

Ground Floor Area before driveways: 6,320 SQ. FT.

DESCRIPTION	AREA	TOTAL
1. CANADIAN TIRE	4,300	4,300
2. GAS BAR	800	800
3. CANADIAN TIRE	200	200
4. GAS BAR	700	700
5. CANADIAN TIRE	1,000	1,000
6. CANADIAN TIRE	200	200
7. CANADIAN TIRE	100	100
TOTAL PAVED AREA	7,500 SQ. FT.	7,500 SQ. FT.

CITY PLAN

SITE DESCRIPTION:
PART OF LOTS 2 AND 3
CONCRETE & TYPING
TOWNSHIP OF SOUTH BAY IN
THE CITY OF PETERBOROUGH
COUNTY OF PETERBOROUGH.

LEGEND:

- 1.0 LAMP STANDARDS (L)
- 1.1.0 LAMP STANDARDS (SHOTS)
- FLUOR LIGHTS
- 2.0 CATCH BASIN (C)
- 2.1.0 CATCH BASIN (SHOTS)
- 3.0 MANHOLE (M)
- 3.1.0 MANHOLE (SHOTS)
- 4.0 FINE INLET
- 4.1.0 FINE INLET (SHOTS)
- 5.0 TRAP
- 5.1.0 TRAP (SHOTS)
- 6.0 Gully
- 6.1.0 Gully (SHOTS)
- 7.0 TRAFFIC STOP SIGN
- 7.1.0 TRAFFIC STOP SIGN (SHOTS ON PARKING LINES)
- 8.0 ONE WAY TRAFFIC SIGN
- 8.1.0 ONE WAY TRAFFIC SIGN (SHOTS)
- 9.0 ASBESTOS
- 9.1.0 ASBESTOS (SHOTS)
- 10.0 MEDIAN BURY ASPHALT AND PAINTED LINES
- 11.0 CONC. SIDEWALK AND CURB

REVISION RECORD

NO.	DATE	DESCRIPTION
1	2000	ISSUED FOR PERMITS
2	2000	ISSUED FOR PERMITS
3	2000	ISSUED FOR PERMITS

RAI Architect Inc.
1800 University Ave., Suite 200
Peterborough, Ontario
Tel: (705) 752-1111

PETERBOROUGH
STORE No. 860

CONCRETE TIRE REAL ESTATE LIMITED

RETAIL STORE AND SERVICE CENTRE

SITE PLAN

PROJECT NO. A01

DATE: 1/2000

FILE NO. 10-000

Risk and Safety Management Plan Area Map Showing PUBLIC RECEPTORS WITHIN HAZARD DISTANCE

Peterborough County

Scale: 1:3 000

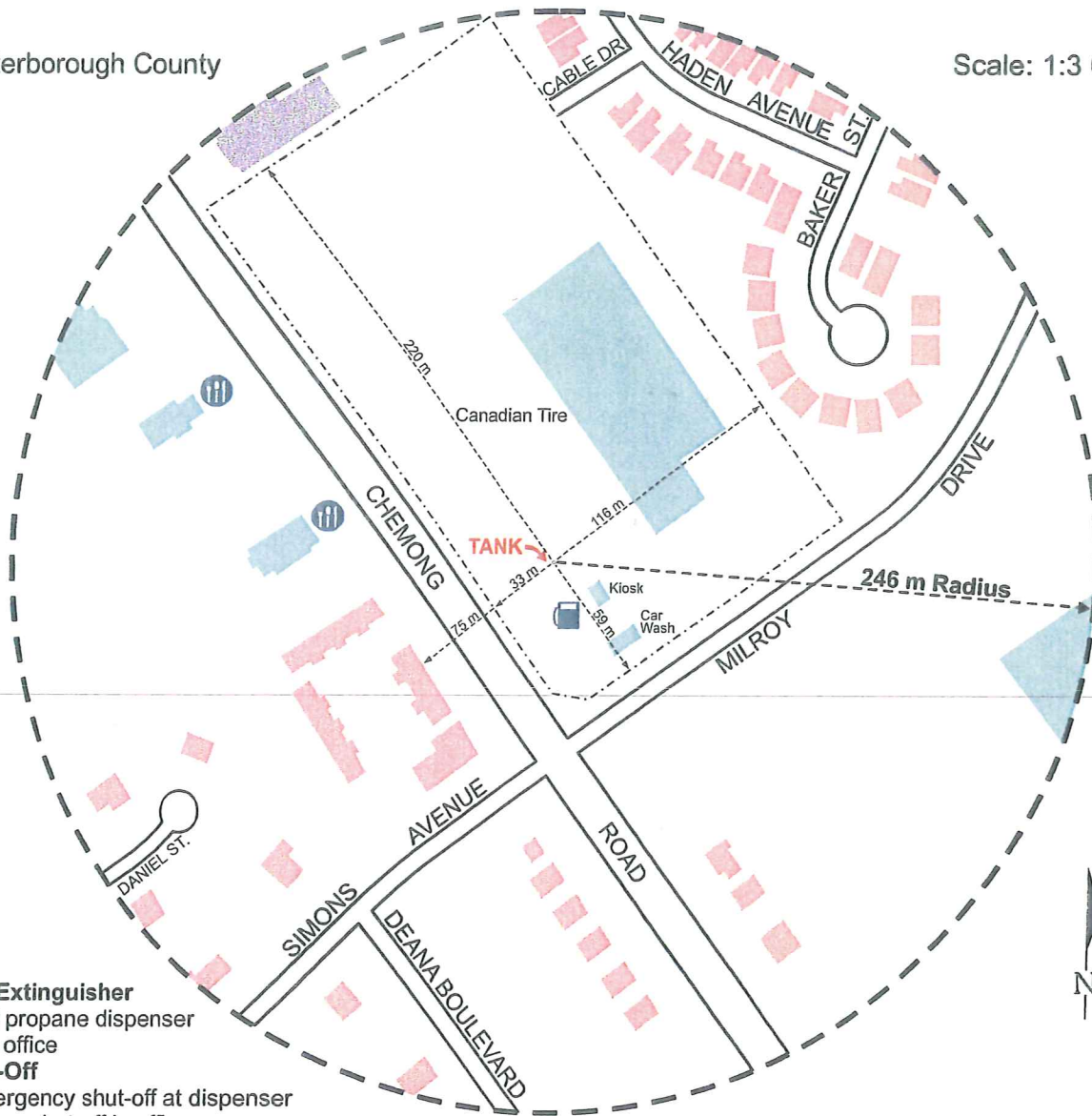

Fire Extinguisher

- 1 at propane dispenser
- 1 in office

Shut-Off

- Emergency shut-off at dispenser
- Power shut-off in office

LEGEND	
	Residential
	Commercial
	Sensitive Institution
	Restaurant
	Gas Station
	Road
	Property Boundary

KennKart Digital Mapping ©2011

Municipal Contact

Brian Horton, CAO
Emergency & Risk Management
Telephone: 705-742-7777 x1810
Email: bhorton@peterborough.ca

GPS Coordinates

44.3251 N, -78.3364 W

Nomimal Water Capacity (USWG)	Distance to Endpoint (m)
500	155
1000	195
1,300	213
1,750	235
1,885	241
2,000	246
5,000	333

Superior Propane Inc. ©2011

Canadian Tire

1050 Chemong Road, Peterborough, Ontario, Canada, K9H 7S2

Pt. Lts. 2 & 3, Con. ERC (Smith), Pts. 1 & 2 PL. 45R12287 S/T LT. 10887, LT. 41797, County of Peterborough